

# WREN Nov/Dec 2021 Gallery Sections

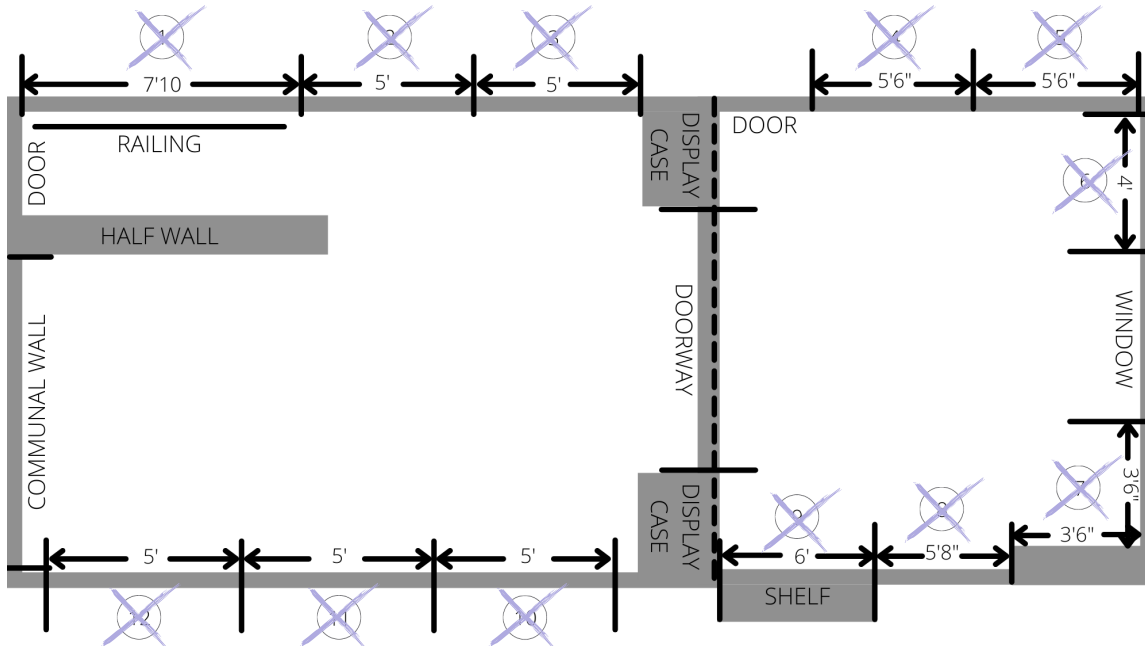

 = section taken

**If all sections are taken, you can join the waitlist, or sign up to be featured on the Communal Wall!**

- |                               |                                   |
|-------------------------------|-----------------------------------|
| 1. 7'10" - above railing only | 7. 3'6" x 3'6" corner full height |
| 2. 5' full height             | 8. 5'8" full height               |
| 3. 5' full height             | 9. 6' - above shelf only          |
| 4. 5'6" full height           | 10. 5' full height                |
| 5. 5'6" full height           | 11. 5' full height                |
| 6. 4' full height             | 12. 5' full height                |